

# ENGINEERING PLANS

FOR

## CRANK PARCEL UTILITY EXTENSIONS

FOR

### LADY LAKE

#### PUBLIC WORKS DEPARTMENT

LAKE COUNTY, FLORIDA  
MARCH, 2010

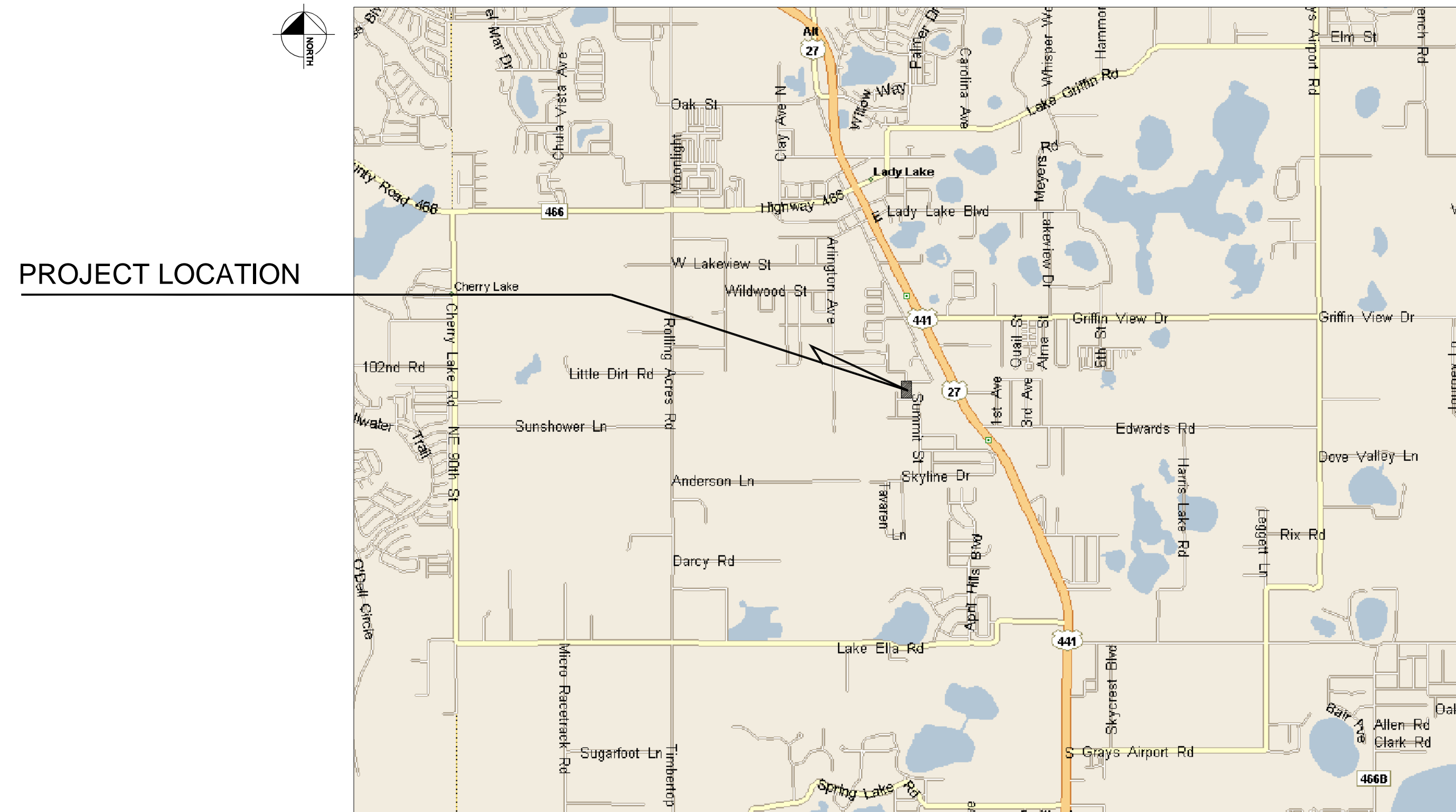
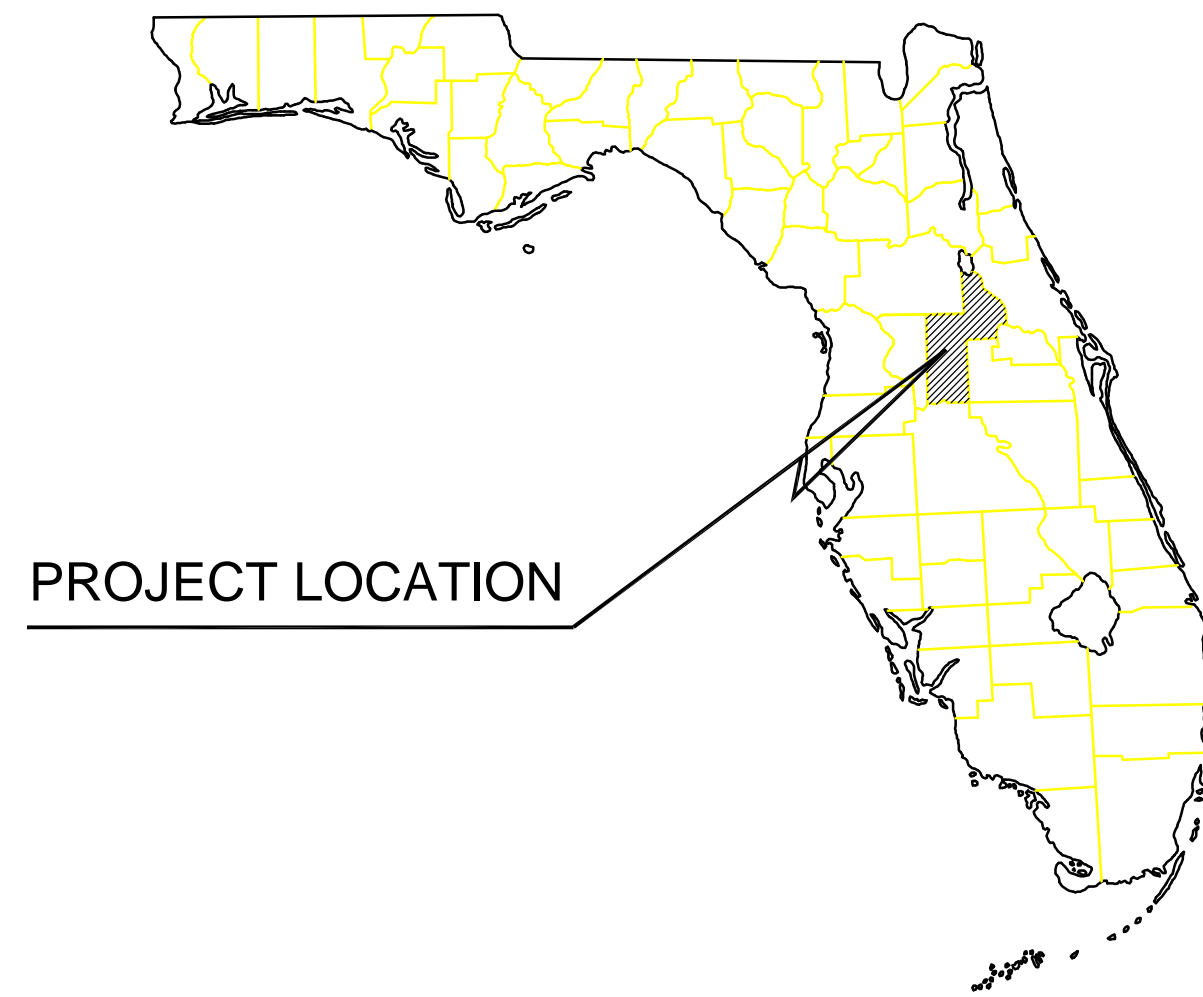

VICINITY MAP

#### INDEX OF SHEETS

- |    |               |
|----|---------------|
| 01 | COVER SHEET   |
| 02 | PLAN SHEET    |
| 03 | DETAILS SHEET |
| 04 | DETAILS SHEET |

REVISION NO.	REVISION DATE
00	00/00/00
01	05/18/10
00	00/00/00
00	00/00/00

#### PROJECT OWNER AND CONSULTANTS

**OWNER:**

LADY LAKE PUBLIC WORKS DEPARTMENT  
136 SKYLINE DRIVE  
LADY LAKE, FLORIDA 32159  
PHONE: (352) 751-1526

**SURVEYOR:**

RHODEN LAND SURVEYING, INC.  
11112 HOWEY CROSS ROAD  
CLERMONT, FLORIDA 34715  
PHONE: (352) 394-6256

**CIVIL ENGINEERING CONSULTANT:**

KIMLEY-HORN AND ASSOCIATES, INC.  
1321 SE 25TH LOOP, SUITE 101  
OCALA, FLORIDA 34471  
PHONE: (352) 671-9451

**DATUM NOTE:**  
ELEVATIONS SHOWN ARE BASED ON NAVD 1988 DATUM.

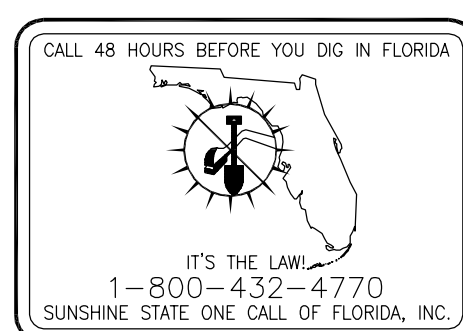

PREPARED BY



© 2010 KIMLEY-HORN AND ASSOCIATES, INC.  
1321 SE 25TH LOOP, SUITE 101, OCALA, FL 34471  
Phone: (352) 671-9451 Fax: (352) 671-9439  
WWW.KIMLEY-HORN.COM CA 00000596

ENGINEER OF RECORD: \_\_\_\_\_  
RICHARD V. BUSCHE, P.E. #58568  
DATE: \_\_\_\_\_

BID SET - NOT FOR CONSTRUCTION