

1 Applicant and Owner: Orange Blossom Gardens Chapel of All Faiths, Inc. and the Village Center
2 Community Development District

3 General Location: 1401 Paradise Drive, within the Orange Blossom Gardens Unit No. 1
4 Subdivision, within Lake County, Florida

5 Acres: Approximately 0.076 Acres

6 Future Land Use: Change from Lady Lake Recreation (P) to Lady Lake Religious Facilities (RF)

7 Graphic representation of this Small Scale Future Land Use Element Map Amendment is shown
8 in the attached "Exhibit A."

9 **SECTION 4: Severability.**

10 The provisions of this Ordinance are declared to be separable and if any section, sentence,
11 clause or phrase of this Ordinance shall for any reason be held to be invalid or unconstitutional,
12 such decision shall not affect the validity of the remaining sections, sentences, clauses or
13 phrases of this Ordinance, but they shall remain in effect, it being the legislative intent that this
14 Ordinance shall stand notwithstanding the invalidity of any part.

15 **SECTION 5: Effective Date.**

16 This ordinance shall become effective as provided in Chapter 163, Florida Statutes.

17 **PASSED AND ORDAINED** this 15th day of July, 2019.

18 Town of Lady Lake, Florida

19 _____
20 Jim Richards, Mayor

21 Attest:

22 _____
23 Kristen Kollgaard, Town Clerk

24 Approved as to form:

25 _____
26 Derek Schroth, Town Attorney

27

EXHIBIT A — Legal Description and Map

1
2 Portion of Parcel ID#: 06-18-24-1100-000-01300; Commence at the most westerly corner of Lot 6,
3 Orange Blossom Gardens Unit One, according to the plat thereof as recorded. In Plat Book 18,
4 Page 9, Public Records of Lake County, Florida; thence run North 41 degrees 21 minutes 30
5 seconds West a distance of 60.00 feet to the intersection of the northwesterly right-of-way line of
6 Wales Plaza with the Northwesterly extension of the northeasterly right-of-way line of Paradise
7 Drive; thence along said northeasterly right-of-way line of Paradise Drive continue North 41
8 degrees 21 minutes 30 seconds West a distance of 120.10 feet to the most westerly corner of
9 property described in official records book 1874, page 2324, public records of Lake County,
10 Florida; thence along the westerly line of aforesaid property run North 48 degrees 38 minutes 30
11 seconds East a distance of 14.00 feet for the point of beginning; thence continue North 48
12 degrees 38 minutes 30 seconds East a distance of 36.00 feet to the southerly boundary of
13 property described in official records book 698, page 2493, public records of Lake County,
14 Florida; thence along said southerly boundary run North 41 degrees 21 minutes 30 seconds West
15 a distance of 98.00 feet; thence departing said line run South 49 degrees 53 minutes 30 seconds
16 West, a distance of 34.00 feet; thence South 40 degrees 11 minutes 26 seconds East, a distance
17 of 98.76 feet to the point of beginning.
18

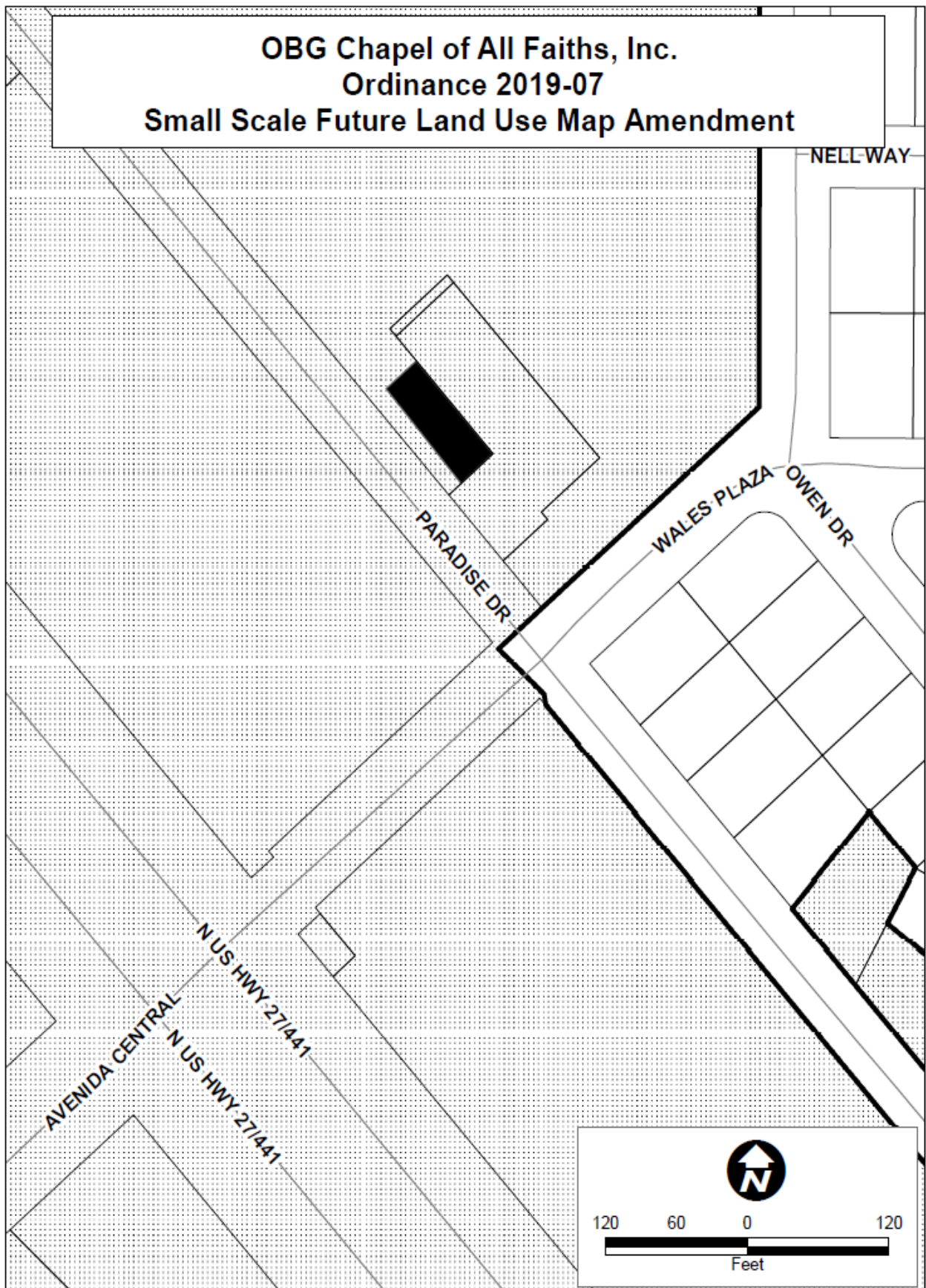

1

2