





1  
2  
3  
4  
5  
6  
7  
8  
9  
10  
11  
12  
13

**EXHIBIT A – LEGAL DESCRIPTION AND MAP**

Parcel ID 21-18-24-0003-000-08000 (AK 1015049); located in Section 21, Township 18 South, Range 24 East: FROM SW COR OF SEC RUN N 89-54-0 E 995.66 FT FOR POB, RUN N 0-0-20 W 485.3 FT, N 89-45-0 E 633 FT TO SW'LY RR R/W, S 27-0-47 E 240.90 FT, N 62-09-32 E 159.81 FT TO A POINT OF CURVATURE, THENCE N'LY ALONG THE ARC OF A CURVE CONCAVE TO THE W, HAVING A RADIUS OF 25 FT, A CENTRAL ANGLE OF 93-39-57, AN ARC DIST OF 40.87 FT TO A POINT ON W'LY R/W LINE OF US HWY 27, THENCE SE'LY ALONG SAID W'LY R/W LINE, ALONG THE ARC OF A CURVE CONCAVE TO THE NE, HAVING A RADIUS OF 2897.93 FT, A CENTRAL ANGLE OF 02-16-55, A CHORD BEARING S 32-38-53 E, AN ARC DIST OF 115.42 FT TO A POINT OF CUSP, THENCE DEPARTING W'LY R/W LINE ALONG THE ARC OF A CURVE CONCAVE TO THE S, HAVING A RADIUS OF 25 FT, A CENTRAL ANGLE OF 84-03-08, A CHORD BEARING N 75-48-55 W, AN ARC DIST OF 36.67 FT TO A POINT OF TANGENCY, THENCE S 62-09-32 W 198.26 FT, S 0-06-0 W 198.71 FT TO S LINE OF SEC, S 89-54-0 W TO POB ORB 5016 PG 1274.

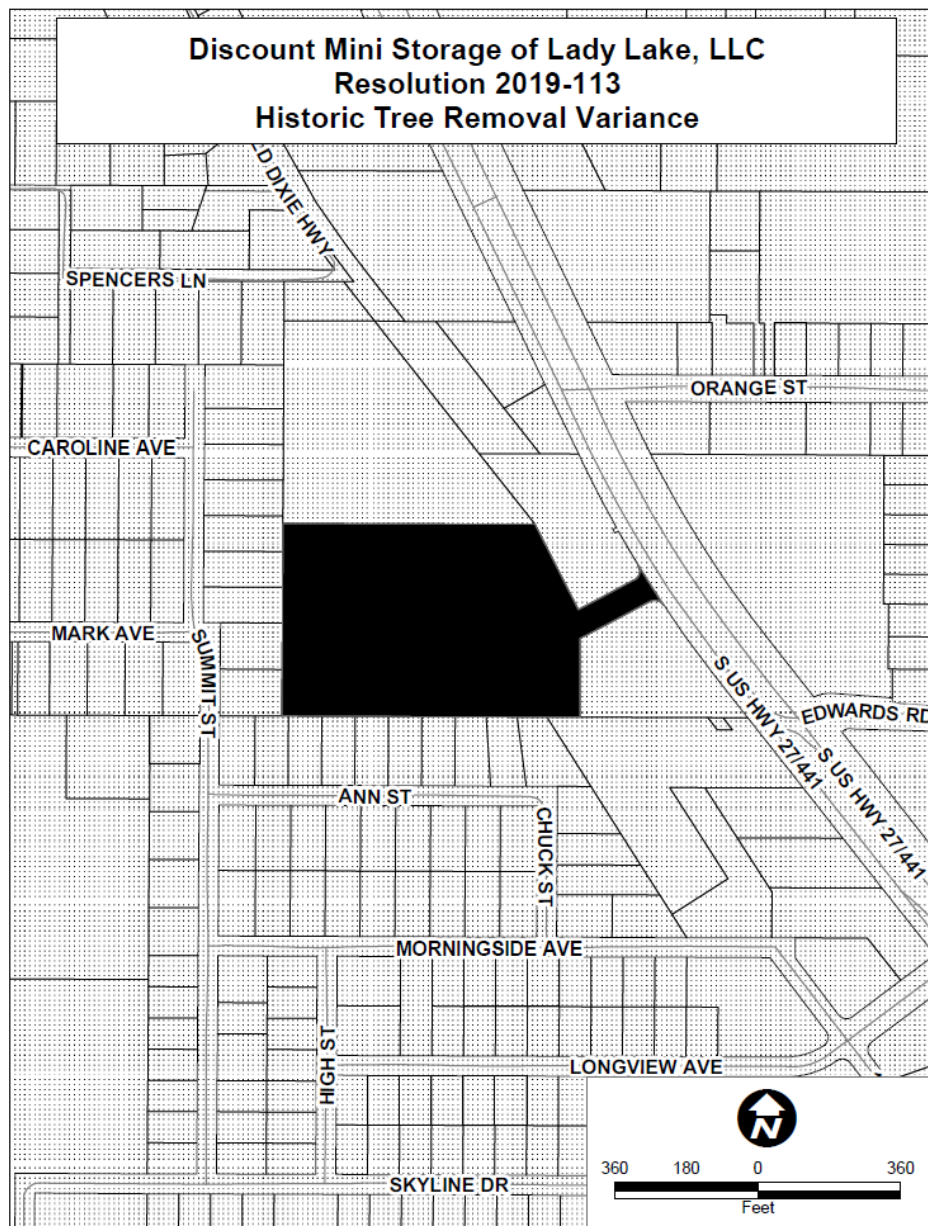

14